

GYM FLOOR STRIPING PLAN

SCALE: 1/8"=1'-0"

NOTE:
1. FLOOR STRIPING TO INCLUDE CENTER COURT LOGO, ONE BASKETBALL COURT, 2 BASKETBALL PRACTICE COURTS, 2 VOLLEYBALL COURTS, 4 BADMINTON COURTS, AND WALKING TRACK.

DOOR HARDWARE SCHEDULE

- A** REUSE EXISTING HARDWARE
- B** EXISTING HARDWARE TO REMAIN- NEW ALUMINUM SILL/ THRESHOLD- SEE DETAIL "4" ON SHEET 4

GENERAL NOTES:

- DOOR HARDWARE TO BE REMOVED FROM EXISTING UNITS "1" AND "2" AND INSTALLED ON NEW DOORS.
- EXISTING DOOR FRAMES TO BE REMAIN IN PLACE AND BE REUSED FOR UNITS "1" AND "2".
- EXISTING DOOR SILLS TO BE REPLACED ON DOORS WHERE INDICATED ON NEW FLOOR PLAN. SEE NEW DOOR SILL/FLOOR DETAILS "4" THIS SHEET.

EXISTING DOOR DETAILS

SCALE: 1 1/2"=1'-0"

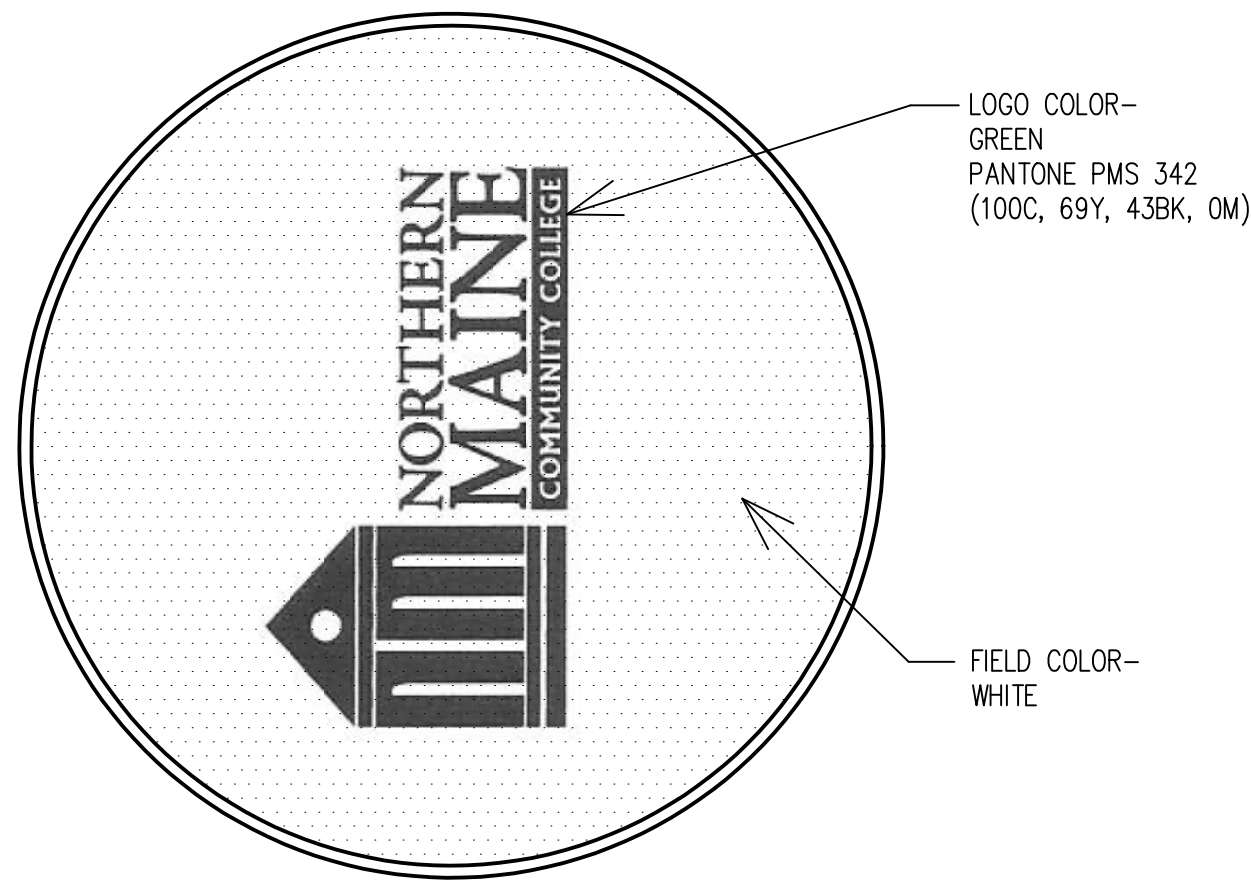
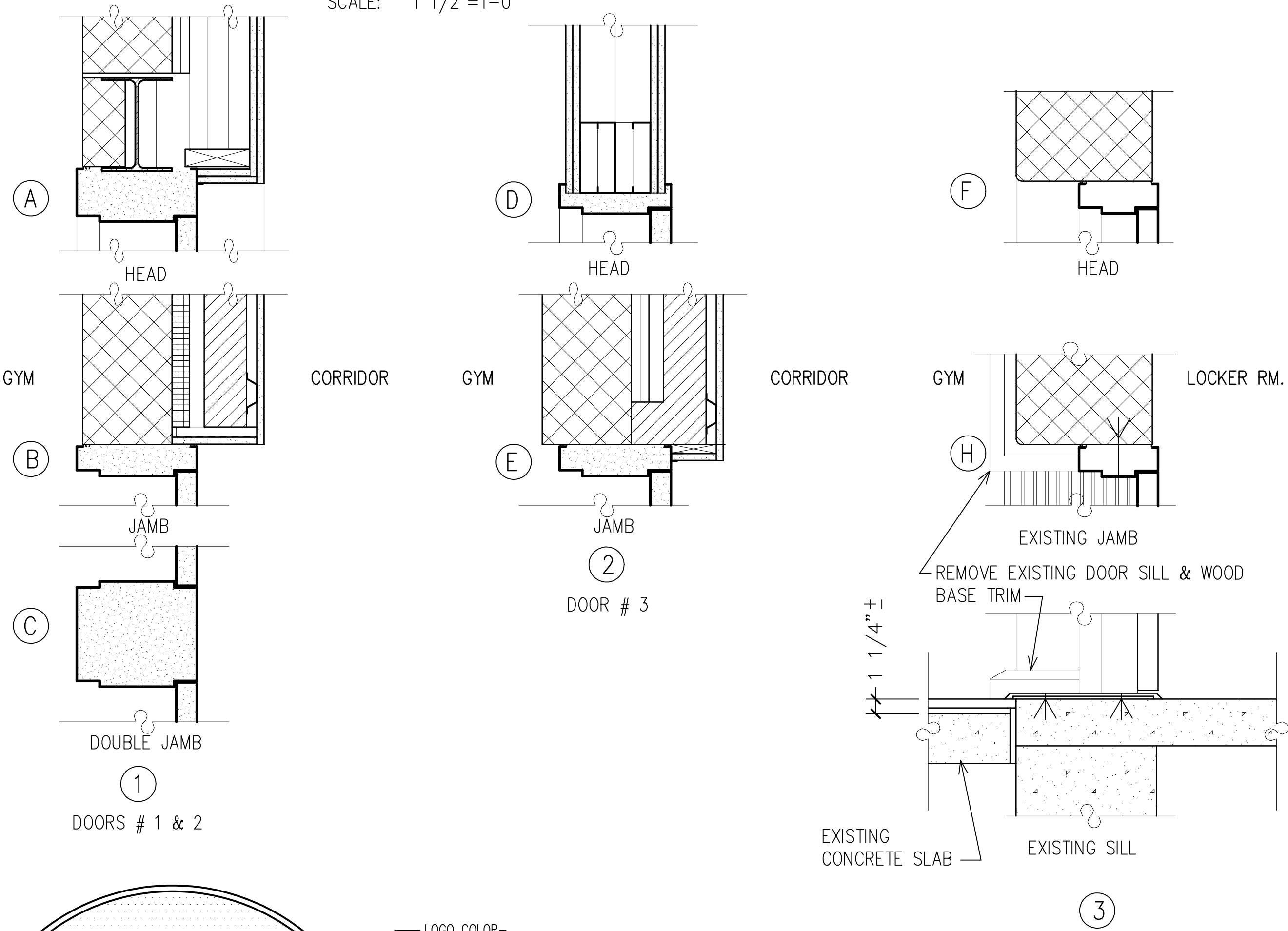

CENTER COURT DETAIL

DOOR SCHEDULE

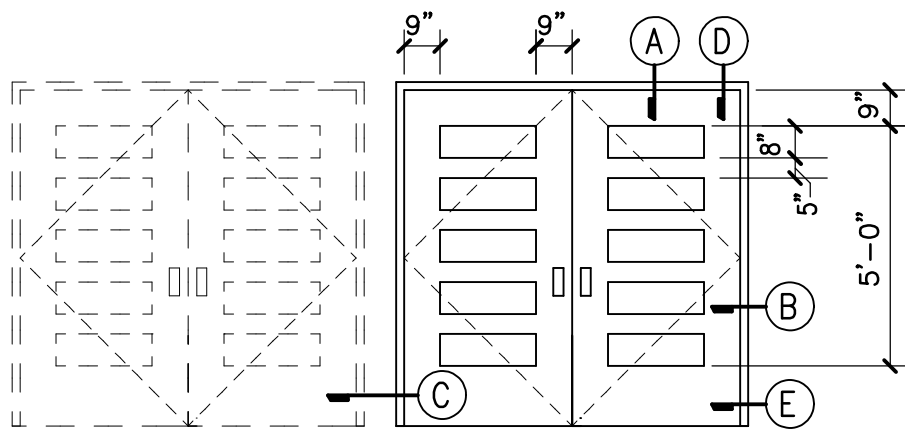

SELECT WHITE BIRCH VENEER, MINERAL CORE
90 MIN. FIRE RATED ENTRANCE DOORS, REUSE
EXISTING 90 MIN. FIRE RATED METAL FRAMES,
FIRELITE 90 MIN. RATED GLAZING, NEW ALUMINUM
SILL/ THRESHOLD- SEE NEW DOOR SILL/ FLOOR
DETAIL "4" SHEET 4

- 1** (2) 1 3/4" X 3'-6" X 7'-0" NEW 90 MINUTE DOOR, EXISTING FRAME
- 2** (2) 1 3/4" X 3'-0" X 7'-0" NEW 90 MINUTE DOOR, EXISTING FRAME
- 3** EXISTING DOOR TO REMAIN

LEGEND

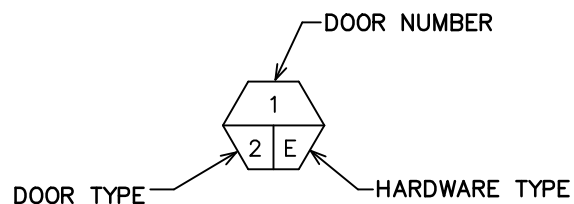

NEW DOOR SILL/FLOOR DETAILS

SCALE: 1 1/2"=1'-0"

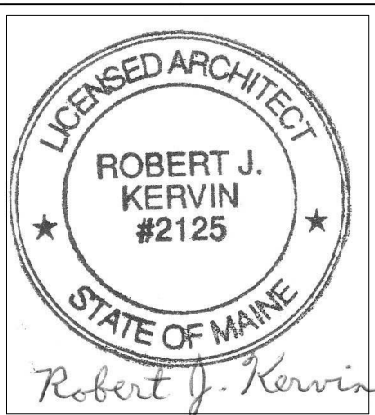
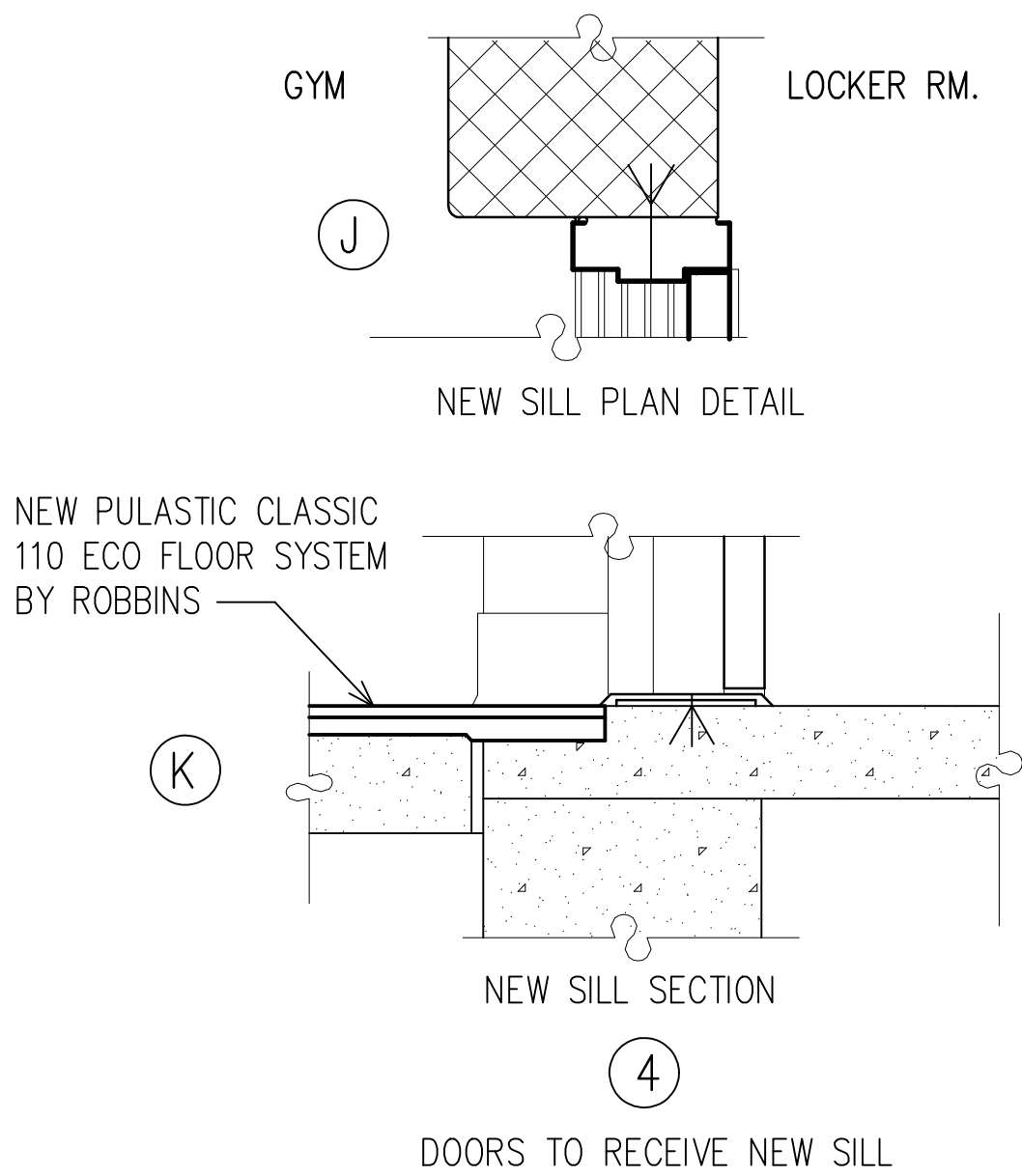

ARCHITECTURAL DESIGNS BY
Robert J. Kervin, Architect
886 BANGOR STREET
HODGDON, MAINE 04730
Maine Licensed Architect
Tel. 207-532-3247
Cell 207-538-6778

OWNER: NMCC
PROJECT: NMCC GYMNASIUM MAINTENANCE PROJECT
33 EDMONT DRIVE
PRESQUE ISLE, MAINE 04769
04769

SHEET TITLE:
GYM FLOOR STRIPING
DOOR & HARDWARE SCHEDULES

DRAWN BY: RJK, RVC
PROJ. DATE: FEBRUARY 1, 2019
SCALE: AS NOTED
JOB NO.: 2-19
REVISIONS:

ISSUED FOR BIDDING
DATE: APRIL 26, 2019

SHEET NUMBER:
4
OF
5